

Quick Installation Guide

1. Introduction

This guide shows how to quickly install and set up AudioCodes' **RXV200 Microsoft Teams Rooms on Android® Compute Unit** bundled with Huawei's **IdeaHub S2 Interactive Display**.

This solution may optionally include AudioCodes RX-PAD Meeting Room Controller. RX-PAD allows users to seamlessly orchestrate productive meeting experiences.

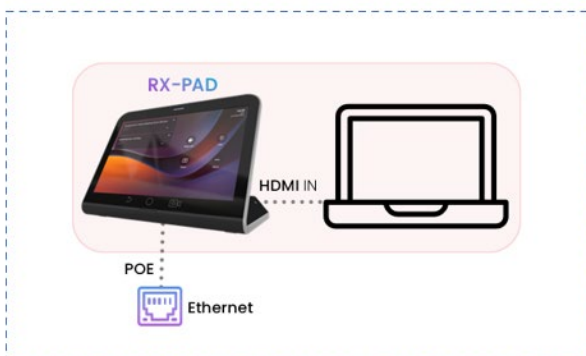

2. Prerequisites

Before beginning the installation, ensure you have the following available.

Equipment

- ✓ **AudioCodes RXV200** compute unit
- ✓ **AudioCodes RX-PAD** Meeting Room Controller (optional)
- ✓ **Huawei IdeaHub S2** – serves as the display and AV peripheral hub

Cables

- ✓ **USB Type-C to Type C cable:** For connecting the RXV200 to the IdeaHub S2. Note that a high-quality USB 3.0 Type C-to-C cable supporting DP Alt Mode is required.
- ✓ **Ethernet cables:** Network connectivity for both RXV200 and RX-PAD

Power

- ✓ 12V 5A Power Adapter for the RXV200 (supplied)
- ✓ RX-PAD Power-over-Ethernet (PoE) is recommended. A 12V 2A Power Adaptor can be ordered separately.
- ✓ Huawei IdeaHub S2 Power Adaptor (supplied)

Network Configuration

- ✓ Ensure RXV200 and RX-PAD are connected to the same network subnet.
- ✓ UDP port 9999 must be open in both directions within the network for pairing.
- ✓ Follow Microsoft requirements for Office365 network configuration: [URLs and IP Address Ranges](#)

Software and Licenses

- ✓ Latest AudioCodes firmware on both RXV200 and RX-PAD, supporting AOSP Device Management
- ✓ Microsoft Teams Rooms Basic or Pro licenses are required to sign Microsoft Teams accounts on AudioCodes MTRA devices.

3. Physical Installation and Cabling

Mount the AudioCodes RXV200 Unit (Optional)

1. For wall mounting, acquire the 'RXV-WALLMOUNT' kit.
2. Mark and drill four holes on the wall, insert screw anchors, and attach the RXV200 unit to the wall-mount plate using the supplied screws.
3. Mount the plate to the wall, connect cables, and secure them with the cable-retention clamp cover.

Connect the RXV200 Unit

- ✓ **Power:** Connect RXV200 to power with a 12V 5A Power Adapter.
- ✓ **Network:** Connect an Ethernet cable to the LAN port on the RXV200.
Alternatively, WIFI can be used for network connectivity.

Connect the RXV200 Unit to Huawei IdeaHub S2

A single USB connection is used for camera, speakers and display.

- ✓ Connect a **USB Type-C cable** from the **RXV200 USB-C 3.0 port** to the **IdeaHub S2 USB Type-C port**.

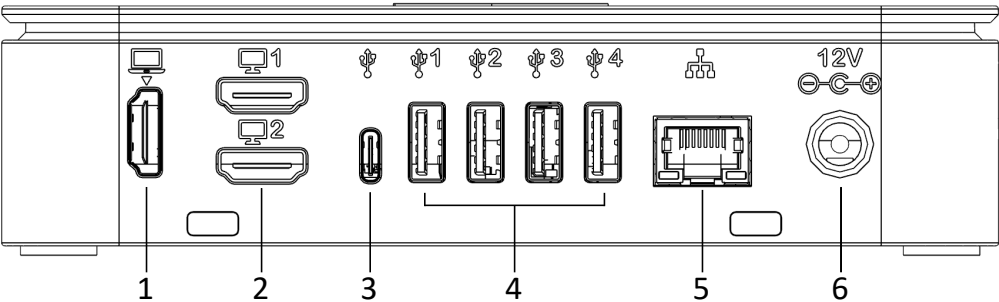

#	Port	Description
1	HDMI Input types	HDMI 2.0 Input
2	HDMI Outputs	2 x HDMI 1.4 Outputs to external screens
3	USB-C 3.0	Connects to the IdeaHub S2 USB port using a USB Type-C cable
4	USB-A 3.0 (x4)	Connects camera, audio peripherals
5	LAN RJ-45	Connects RXV200 to the network
6	DC IN 12V 3A	Connects to 12V adapter (power)

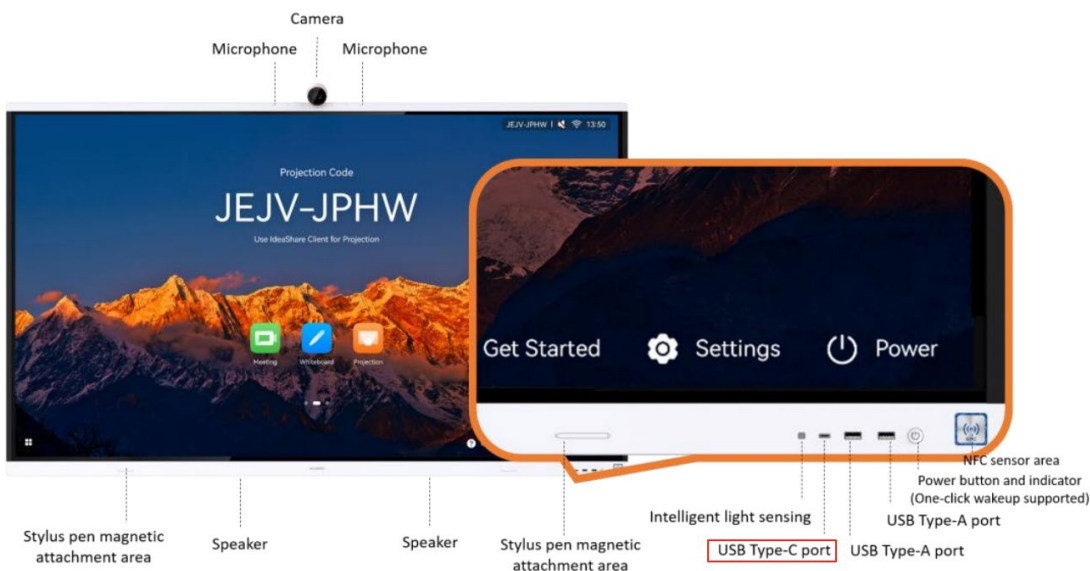

Connect the AudioCodes RX-PAD

- ✓ **Positioning:** Place the RX-PAD on the conference table for ease of use.
- ✓ **Network and Power:** Connect an Ethernet cable to the LAN PoE port on the RX-PAD. This will power the device via PoE.
 - If PoE is unavailable, use a separate 12V 2A power adapter (can be ordered separately).
 - Alternatively, WIFI can be used for network connectivity.

Power the Huawei IdeaHub S2

Ensure the IdeaHub S2 is connected to its power supply and turned on.

4. Initial Setup of Huawei IdeaHub S2

Restore Factory Settings (If Not New)

If the IdeaHub S2 is not brand new, it is recommended to restore factory settings.

1. While the IdeaHub is running, press and hold the RESET button (located under the TOUCH port on the left side) for 13 seconds.
2. Release when prompted to confirm.

Complete Initial Deployment

Follow the on-screen Setting Wizard on the IdeaHub S2 touchscreen to smoothly complete initial deployment:

- ✓ Selecting language and region
- ✓ Selection time zone
- ✓ Configure wired network or Wi-Fi network
- ✓ Enable enhanced services
- ✓ Set up an Administrator account (essential for web interface access)

Perform IdeaHub S2 System Configuration

- ✓ **Software update:** Navigate to **Touchscreen > System&Update > Auto Update Settings** to enable automatic software updates.
- ✓ **Enable USB priority for peripherals:**
 - To allow the RXV200 to fully utilize the IdeaHub S2 camera and microphone, go to **Settings > Advanced > Input/Output > Camera & Microphone Settings** and select **Type-C first**.
 - Ensure that USB debugging is *not* enabled on the IdeaHub S2, as this is a requirement for successful microphone and camera calls.

5. Configuring AudioCodes RXV200

Configure Bundle (If Needed)

The RXV200 units are usually preconfigured.

If you need to change the preconfigured bundle, access **Settings > Bundle** on the RXV200 and select the appropriate option (probably RXV200 + Touch Screen).

Pair RX-PAD with RXV200

1. Ensure both the RX-PAD and RXV200 are running the latest firmware and are connected to the same network (subnet).
2. If the RX-PAD is connecting via Wi-Fi, you must first enable Wi-Fi on the RXV200 using a USB mouse connected to it (**Settings > Wi-Fi**).
3. Connect both devices to the network; the pairing process should be initiated automatically.
4. On the RX-PAD, select the specific RXV200 device (identified by its serial number) and tap **PAIR**.

Sign into Microsoft Teams

After successful pairing, both the RX-PAD and the IdeaHub S2 (which serves as the MTRA display) will present a code and instruct you to go to <https://microsoft.com/devicelogin>.

1. On a separate computer or mobile device, open a web browser and navigate to <https://microsoft.com/devicelogin>.
2. Enter the code displayed on the RX-PAD and IdeaHub S2.
3. Follow the on-screen prompts to sign in using your Microsoft Teams Room resource account. This operation requires a Teams Rooms Basic or Teams Rooms Pro license.
4. Once the setup is complete (which may take several minutes), close your web browser.

At this point, the Microsoft Teams homepage should be displayed on both the IdeaHub S2 and the RX-PAD.

6. General MTR on Android functionality

For comprehensive information regarding the core functionalities of Microsoft Teams Rooms on Android, please refer to the [Microsoft Teams Rooms \(Android\)](#) document.

7. IdeaHub Screen Sharing via HDMI

With a dual-screen setup, you can enjoy a smooth whiteboard writing experience, by using the secondary IdeaHub display for sharing a whiteboard during meetings. For this setup:

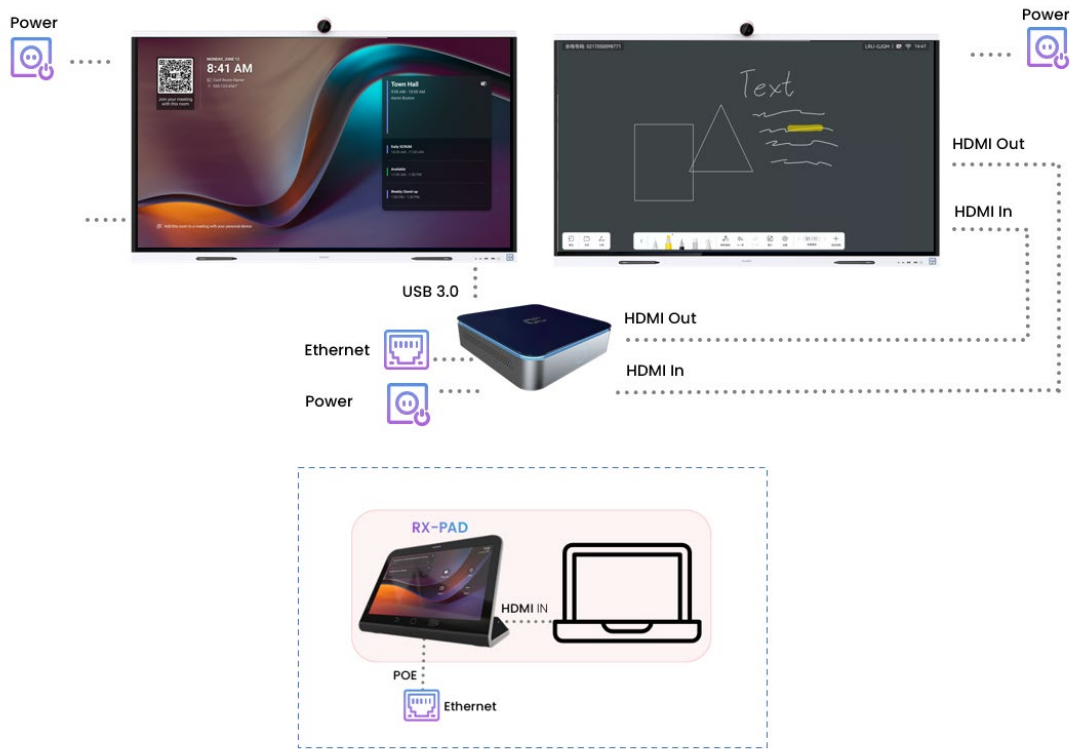

1. Connect the secondary IdeaHub to the RXV200 using HDMI connections:
 - Connect the HDMI OUT port on the side of the IdeaHub to the RXV200 HDMI IN port.
 - Connect the HDMI IN port on the side of the IdeaHub to the RXV200 HDMI OUT port.

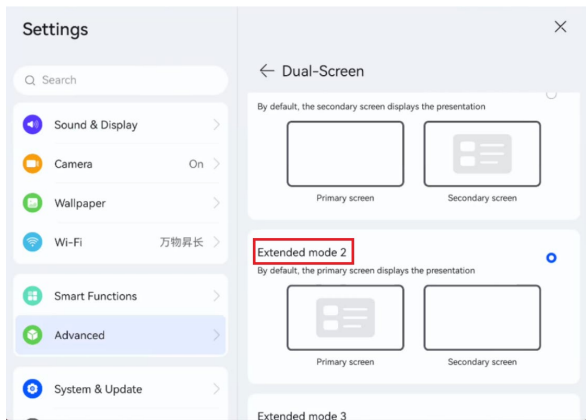

2. On the secondary IdeaHub, navigate to **Settings > Advanced Settings > Input/Output > Dual Screen**, and select **Extended mode 2**.



After the setup, users can share the whiteboard during a meeting, as follows:

- ✓ To start sharing, tap the share icon  at the bottom of the RX-PAD or on the touch screen, and select the name of the secondary IdeaHub.
- ✓ While sharing, the share icon changes to . To stop sharing, tap it.



Before switching back to the MTR mode, ensure that the cloning function is disabled. Otherwise, video loopback will occur.

8. Technical Documentation

Please refer to the guides below for more information:

Topic	Reference
RXV200 setup guide	RX-PAD Pairing Guide
RXV200 technical specification	RXV200 Datasheet
RXV200 user & administrator manual	RXV200 MTRA User's and Administrator' Manual
RX-PAD technical specification	RX-PAD Room Meeting Controller Datasheet
RXVCam50 camera technical specification	RXVCam50 Video Camera Datasheet
RXVCam70 PTZ camera technical specification	RXVCam70PTZ Camera Quick Guide
RXVCam360 camera technical specification	RXVCam360 Video Conferencing Camera Quick Guide
RX15 speakerphone technical specification	RX15 Speakerphone Datasheet

International Headquarters

Naimi Park
6 Ofra Haza
Or Yehuda, Israel
Tel: +972-3-976-4000
Fax: +972-3-976-4040

AudioCodes Inc.

80 Kingsbridge Rd
Piscataway, NJ 08854, USA
Tel: +1-732-469-0880
Fax: +1-732-469-2298

Contact us: <https://www.audiocodes.com/corporate/offices-worldwide>

Website: <https://www.audiocodes.com/>

©2025 AudioCodes Ltd. All rights reserved. AudioCodes, AC, HD VoIP, HD VoIP Sounds Better, IPmedia, Mediant, MediaPack, What's Inside Matters, OSN, SmartTAP, User Management Pack, VMAS, VoIPerfect, VoIPerfectHD, Your Gateway To VoIP, 3GX, AudioCodes One Voice, AudioCodes Meeting Insights and AudioCodes Room Experience are trademarks or registered trademarks of AudioCodes Limited. All other products or trademarks are property of their respective owners. Product specifications are subject to change without notice.



FCC WARNING

Prior to operating this device, refer to the device's [Regulatory Information and FCC warnings](#).

Notice Information

Information contained in this document is believed to be accurate and reliable at the time of printing. However, due to ongoing product improvements and revisions, AudioCodes cannot guarantee accuracy of printed material after the Date Published nor can it accept responsibility for errors or omissions. Updates to this document can be downloaded from <https://www.audiocodes.com/library/technical-documents>.

This document is subject to change without notice.

Date Published: Sep-28-2025

Document #: LTRT-18410

