

Quick Guide

1. Before Installing

Congratulations on purchasing your **AudioCodes C430HD for Microsoft Teams IP Phone!**

Before installing your phone, make sure the following items are included in the shipped box:

- ✓ C430HD IP Phone
- ✓ AC power adapter (optional)
- ✓ Cat 5e Ethernet cable
- ✓ Handset
- ✓ Handset cord
- ✓ Desktop stand with two screws

2. Physical Description



3. Cabling the Phone



Warning: Prior to connecting power, refer to the [Compliance and Regulatory Information](#) document.

To cable the phone:

1. Connect the short, straight end of the handset cord to the handset, and the longer straight end of the cord, to the handset jack on the phone.
2. (Optional) Connect a headset to the USB port.
3. Connect the RJ-45 LAN port to your LAN network (LAN port or LAN switch/router) with a CAT 5 / 5e Ethernet cable.
4. Connect the RJ-45 PC port to a computer with a CAT 5 / 5e straight-through Ethernet cable.
5. Connect the DC plug of the supplied PS to the phone's DC 12V power jack, and then connect the PS to the electrical wall outlet. When the phone powers up, all the LEDs momentarily light up.

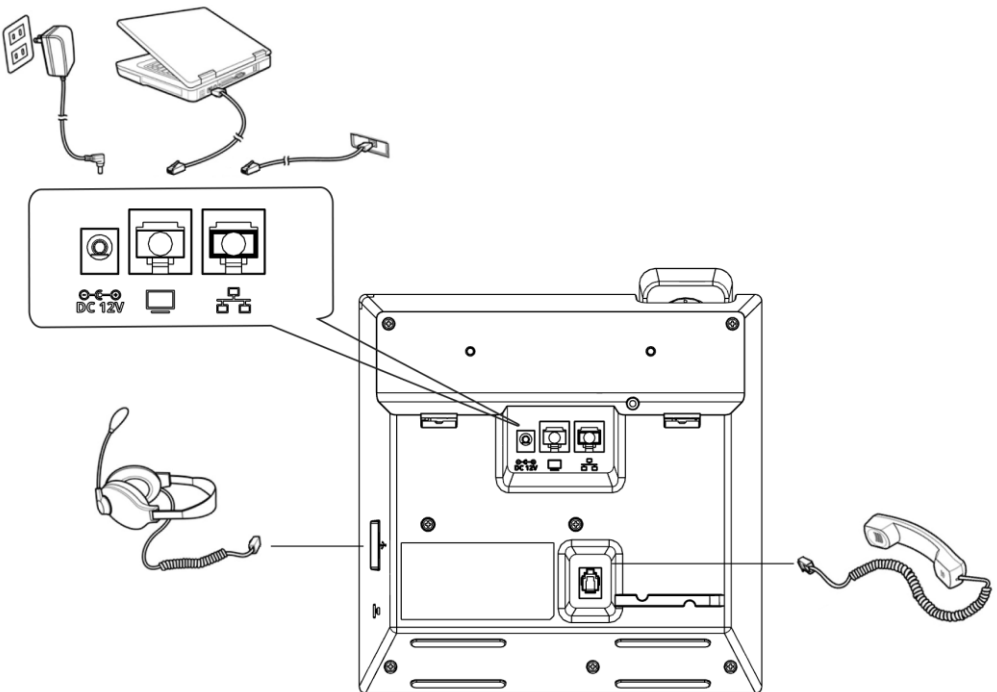

4. Mounting Phone on Desktop

Your phone is shipped with a desk stand.

To desk mount phone:

1. Align the two hooks of the desk stand (supplied) with the corresponding slots on the phone base.
2. Gently push the stand down until it snaps securely into place.
3. Secure the stand to the phone by fastening the two screws (supplied).

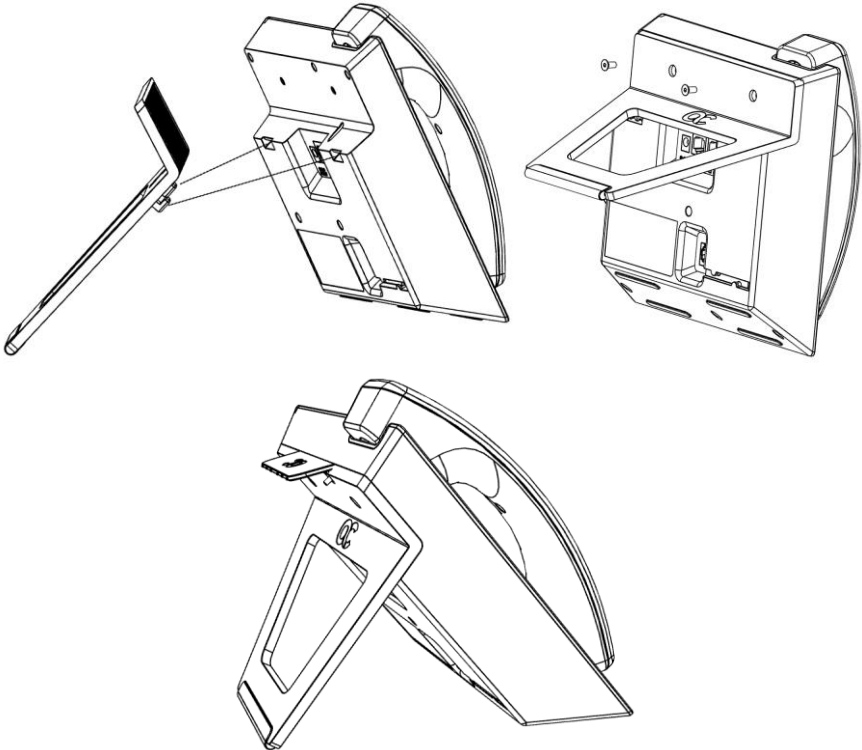

5. Mounting Phone on Wall

Use AudioCodes wall-mounting bracket kit (separate orderable item) to mount the phone on a wall. It allows you to mount the phone anywhere on a wall or to hang it on your Ethernet wall plate.

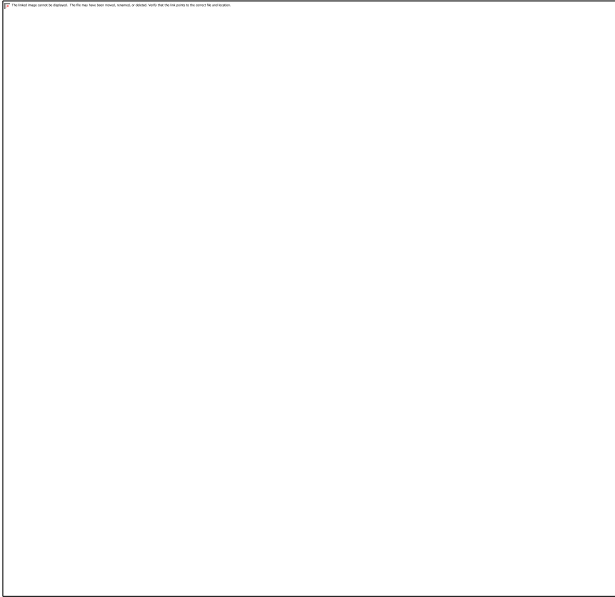

To wall-mount the phone:

1. Align the two clips of the wall-mounting bracket (separate orderable item) with the corresponding slots on the bottom of the phone.
2. Gently push the bracket down until it snaps securely into place.
3. Secure the bracket to the phone by inserting the two screws.

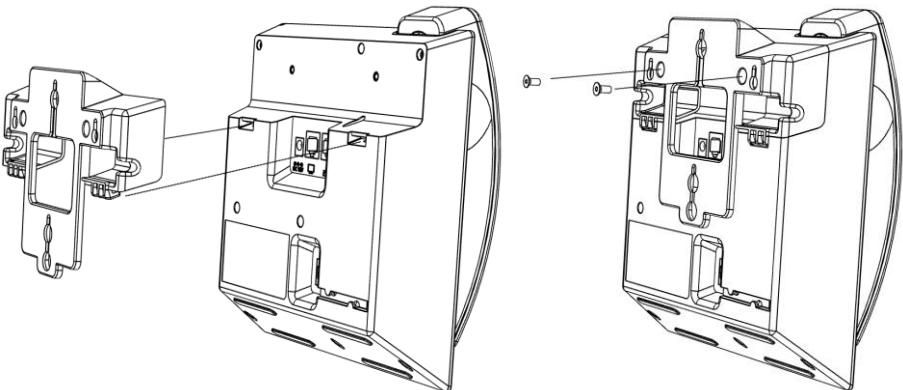

4. Mount anywhere on a wall

- a. Mark the locations of the screw holes on the wall.
- b. Drill a hole in the wall for each location.
- c. Insert wall anchors (not supplied) into the holes and insert screws (not supplied) into them.
- d. Leave a gap (approx. 5 mm) between screw head and wall for hanging the mounting bracket.
- e. Hang the bracket (attached to phone) on the screw heads and tighten the screws if necessary.

5. Hang on an Ethernet wall plate

- a. On the Ethernet wall plate, locate its two mounting standoffs used to wall-mount an IP phone:

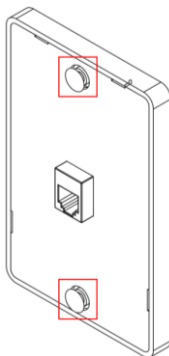

- b. Align the bracket's holes (attached to the phone) over the Ethernet wall plate's mounting standoffs shown in the preceding figure.



Note: The holes in the bracket (attached to the phone) comply with multiple mounting standoffs on Ethernet wall plates available in the market.

- c. Press the phone to hang it on the standoffs.

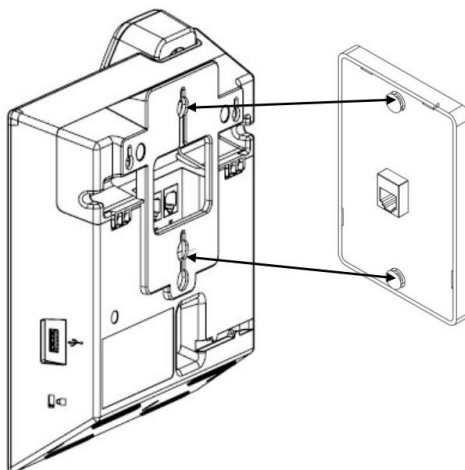

6. Signing in

To sign in with your username and password:

1. After connecting the phone to the network, it starts up and the following is displayed:



2. Open your web browser and navigate to <https://microsoft.com/devicelogin>:

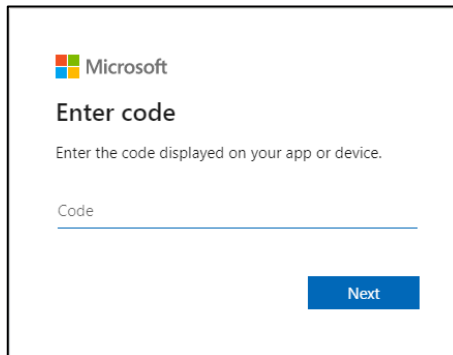

3. Enter the code provided by the phone, and then click **Next**.
4. In the 'Pick an account' screen, double-click the account (or click + to use another):

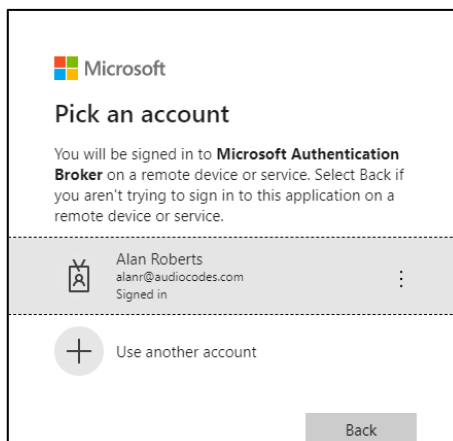

5. Enter your password (same password for your PC), and then click **Sign in**:

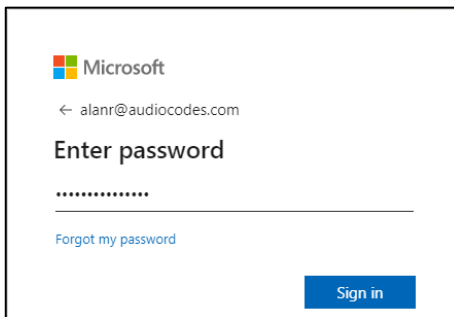

6. Navigate to and select **Got it**; the 'home' screen is displayed. You've successfully signed in to the phone.

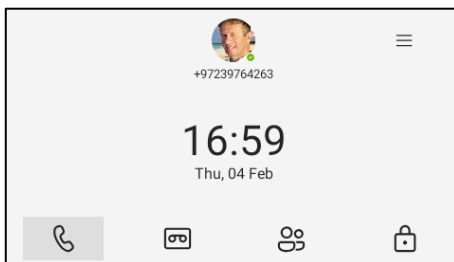

To sign out:

1. Navigate to and select .
2. Navigate to and select **Settings** and then the **Sign out** option.

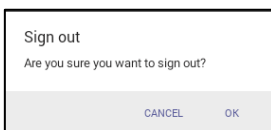
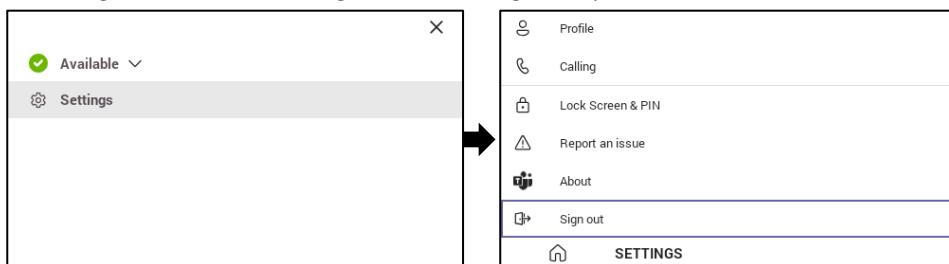

3. Select **OK**; you're signed out of the phone.

7. Changing your Presence Status

 To change your presence status:

1. Navigate to and select  and then navigate to and select the current presence status displayed:

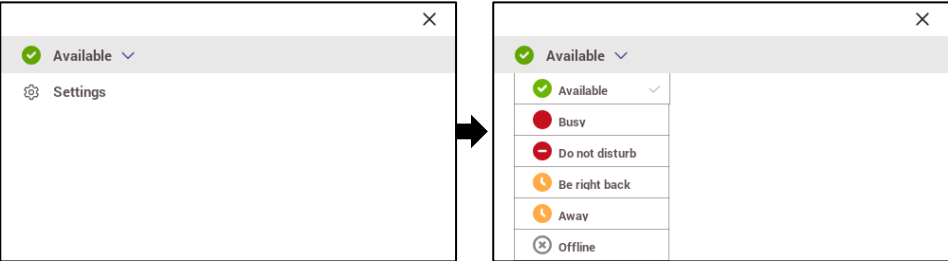

2. Navigate to and select the status you want.

8. Basic Phone Operations

For basic phone operations, refer to Microsoft documentation, and AudioCodes' [C430HD User's and Administrator's Manual](#).

Notice Information

Information contained in this document is believed to be accurate and reliable at the time of printing. However, due to ongoing product improvements and revisions, AudioCodes cannot guarantee accuracy of printed material after the Date Published nor can it accept responsibility for errors or omissions. Updates to this document can be downloaded from <https://www.audiocodes.com/library/technical-documents>.

This document is subject to change without notice.

Date Published: December-15-2024

Document #: LTRT-13442

